

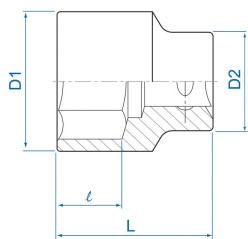

## 6330M

### **M** Douille standard métrique 12 pans 3/4"

DIN 3124

- Métrique
- Chrome Vanadium, finition chromée polie



	Dimension (mm)	D1 (mm)	D2 (mm)	L (mm)	l (mm)	Poids (g)
633017M	17	26	32,7	51	14	187
633019M	19	30	36	52	14	225
633021M	21	32	36	52	16	228
633022M	22	33	36	52	16	230
633023M	23	34	36	52	16	237
633024M	24	35	36	52	17	240
633026M	26	36	35	52	17	243
633027M	27	38	36	52	19	238
633028M	28	39	36	52	19	233
633029M	29	40	38	52	19	261
633030M	30	42	38	54	21	295
633032M	32	44	38	56	23	317
633033M	33	46	40	56	23	351

633034M	34	47	42	57	24	400
633035M	35	48	42	58	25	406
633036M	36	50	42	58	25	434
633038M	38	52	45	60	27	497
633041M	41	56	45	64	29	581
633042M	42	57	45	64	29	591
633046M	46	62	47	68	34	724
633048M	48	64	48	70	34	775
633050M	50	68	48	72	34	889
633054M	54	72	50	75	35	1070
633055M	55	74	50	76	37	1115
633058M	58	77	50	78	37	905
633060M	60	80	50	78	40	1250
633063M	63	83	55	81	40	1445
633065M	65	85	58	83	43	1565
633070M	70	92	58	88	46	1875